

# MICRO SYS TEM

A.A.G.  
**STUCCHI**  
  
**EUTRAC**

## MICRO - When small matters

**MICRO** is the A.A.G. Stucchi low-voltage product family of **miniaturized tracks and components** resulting in a product that can make a difference in lighting projects where **aesthetics and attention to detail are fundamental**.

Micro range offers different track profiles to give the maximum flexibility to lighting projects. The tracks have **the same "smart core" with integrated DATABUS** for light control that makes it technically at the cutting edge.

At the same time, as tracks have the same cutting edge **"smart core"**, it provides freedom and flexibility in design as it is the base for developing customized profile tracks, maintaining compatibility with the system.

## Tracks tech info

Discover all

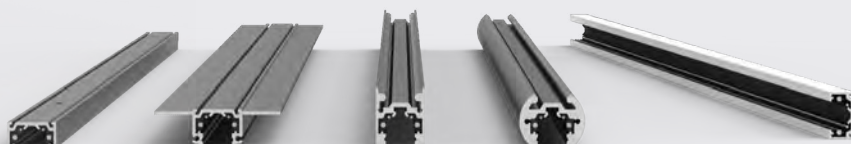

\* J colour:  
white outside  
black inside

2A-48Vdc/4A-24Vdc  
1 circuit + Data Bus: +/- 10A/0-60V + D+/D-

### Materials

External extruded body in aluminium  
Available colours: black / white / J\* embossed  
Insulated extruded body in PVC  
Copper conductors

1000mm



2000mm



3000mm

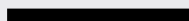

## MICRO adapters

Discover all



Mechanical single spot adapter



Double spot adapter



Adapter for LED board  
electrical connection



Flexible mechanical  
single spot adapter

## MICRO connections

Discover all



End feed



Concealed end-feed with wire



Joining connector



L feed



L feed ceiling-wall



Adjustable corner

## Track fixing accessories examples

Discover all

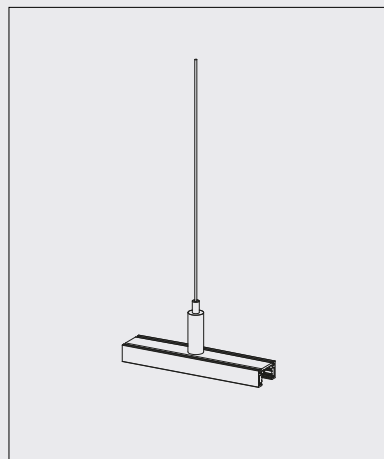

Ceiling/Suspended track

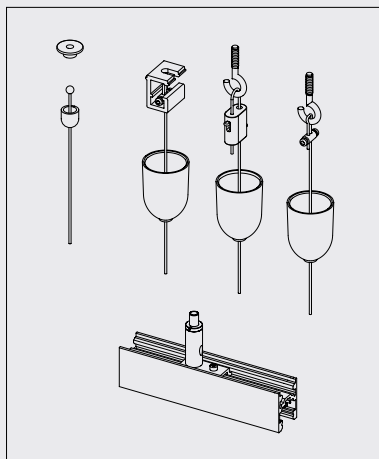

Double emission track

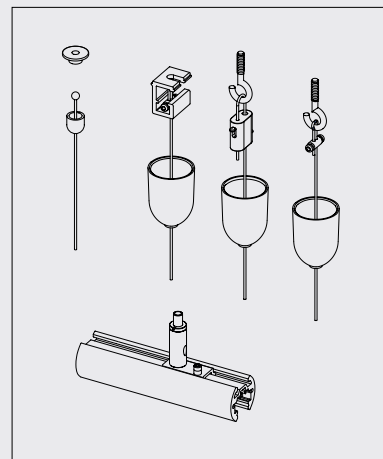

Round track



## SENZAFINE

- 1 - SENZAFINE MICRO M22-M UGR / LENS
- 2 - SENZAFINE FLAT M11 OPAL
- 3/4 - SENZAFINE FLAT M11 UGR / LENS
- 5 - SENZAFINE MICRO M22A-M ADJUSTABLE UGR / LENS
- 6 - CURVED ADAPTER 9609 WITH SPOTLIGHT

## Ceiling track



## Trimless track

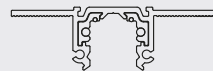
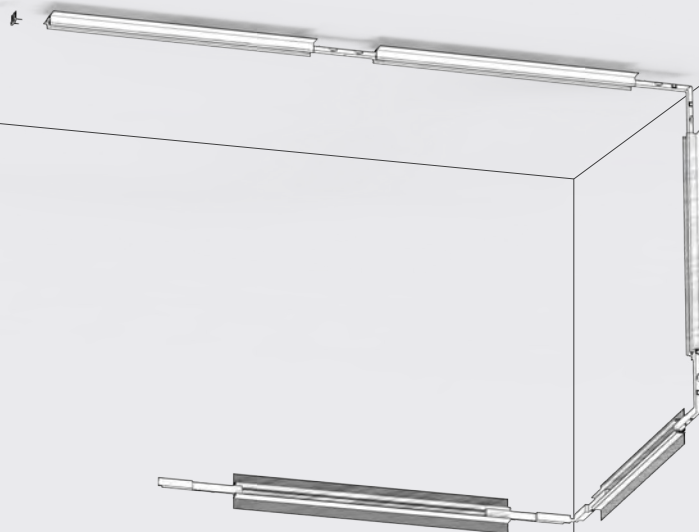

Trimless track with SENZAFINE FLAT OPAL and spotlights

## H track

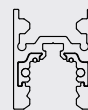
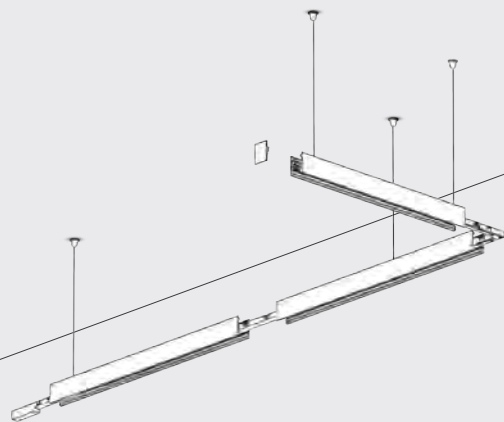

H track with spotlights and indirect light



## Round track

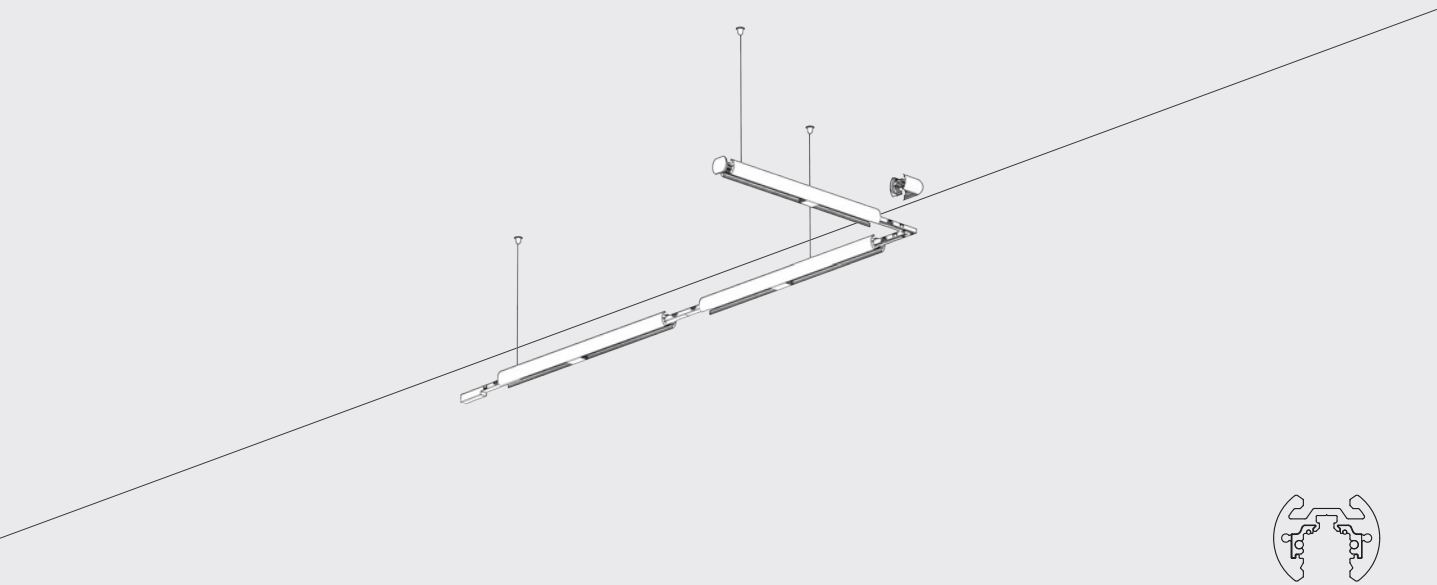

Round track with suspensions and indirect light